

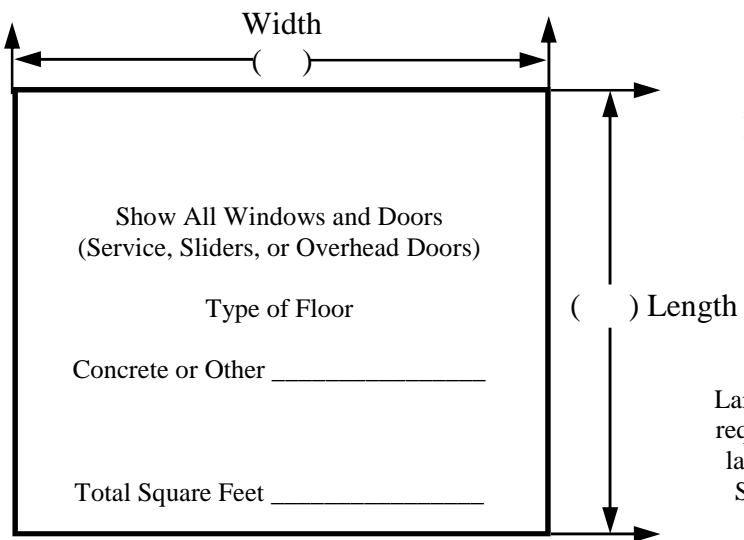

**125 N. DAVIS
VICKSBURG, MI 49097**
 Phone: (269) 345-0120
 (269) 649-0626
 1(800) 468-7170
 Fax: (269) 649-2127

BASIC POLE BARN

Name _____
 Permit #: _____
 Snow Load: **30# Required** _____
 Girt Size: _____
 Purlin Size: _____
 Pole Spacing: _____ **O.C.**
 Header Size: _____
 Truss Spacing: _____ **O.C.**
 Truss Support Girt Size: _____
 Treated Bottom Girt Size: _____
 Pole Size (Treated): _____
 Pole Grade **Min. Ret. AWWA LP22 0.60# pfc**
 Engineered Truss Drawing Required
 Lateral Bracing to Truss Mfg. Specs.
 Roof Materials: _____
 Siding Materials: _____
 Floor Depth: _____

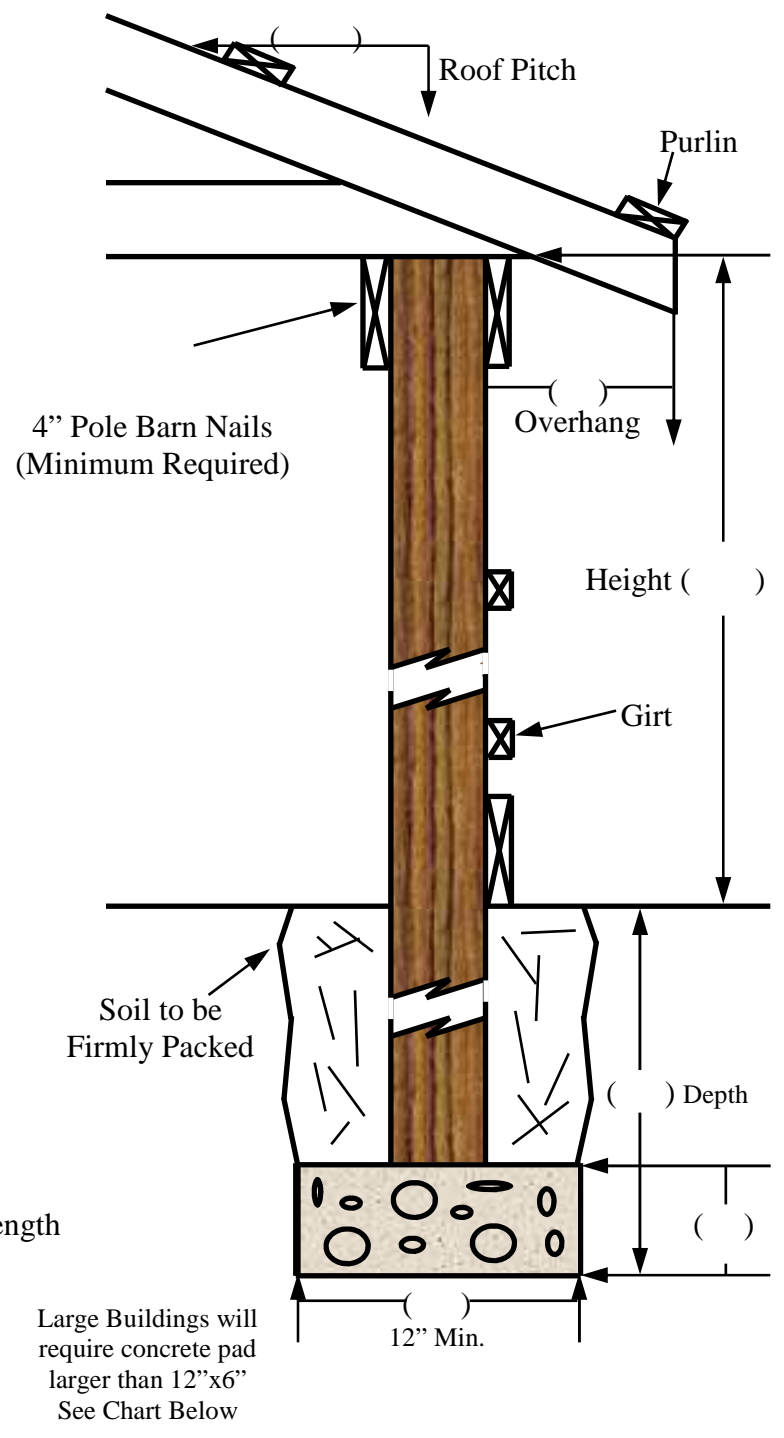

Large Buildings will require concrete pad larger than 12"x6"
 See Chart Below

Building Width		20'	24'	26'	28'	30'	32'	34'	36'	40'
8' post spacing	Hole Diameter	12"	14"	16"	17"	17"	18"	18"	19"	20"
	Concrete Thickness	6"	7"	8"	8.5"	8.5"	9"	9"	9.5"	10"
10' post spacing	Hole Diameter	16"	17"	18"	18.5"	19"	20"	20.5"	21"	22"
	Concrete Thickness	8"	8.5"	9"	9.25"	9.5"	10"	10.25"	10.5"	11"